



 L	3500.5000
 L	500-700
	600/50x22.5
 [cm]	60-90
 [KM/kW]	70/51
 kg	6400, 6700

Standard:

- own independent hydraulic system with PTO powered pump,
- oil cooler of the independent hydraulic system,
- “DANFLOSS” hydrostatic drive
- “DANFLOSS” hydraulic motors,
- electromagnetic control of working functions with a switch **A**
- “FINDER” electric steering,
- “BROEKEMA” conveyors and separators,
- two potato sorters **B**
- hydraulically adjusted intake conveyor **C**
- spheroidal cast iron wheels,
- automatic tensioner for belt drive chains,
- rubber coated bottom of the potato conveyor **D**
- adjustable elliptical vibrator of the first belt,
- 3-panel ploughshare,
- ploughshares with a hinged flap **E**
- hydraulically lifted digger
- hydraulically adjusted drawbar **F**
- hydraulic support foot **G**
- hydraulically turned drive wheels **H**
- wheel direction indicator **I**

- central mechanical lubrication of bearings and certain pins **J**
- smooth adjustment of left axle spacing **K**
- tyres 600/50x22.5 – tyre width 60cm
- drive wheels with brakes (pneumatic or hydraulic),
- automatic parking brake,
- bearings – “SKF” “NSK” “PBF KRAŚNIK”,
- lamella roller sealing,
- polyurethane elements:
 - conveyor rollers,
 - intake shafts,
 - intake rollers,
 - intake blades,
 - haulm intake rollers,
- LED lights back and front,
- toolbox,
- lower hitch-type transport bracket
- unloading height 3.85m,
- wide-angle PTO,
- requires 1 pair of hydraulic outputs,
- double-braided hydraulic hoses 330 bar.

Price:

Single row potato harvester standard	KARTOFFEL	71 905 €
--------------------------------------	-----------	----------



A

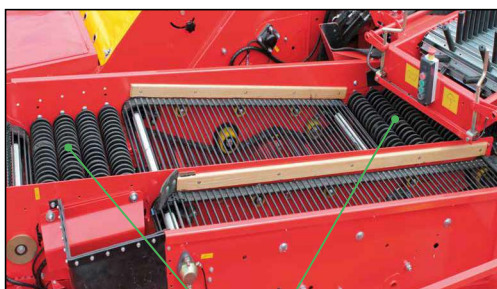

B



C



D



E



F

G



H



I

J



K

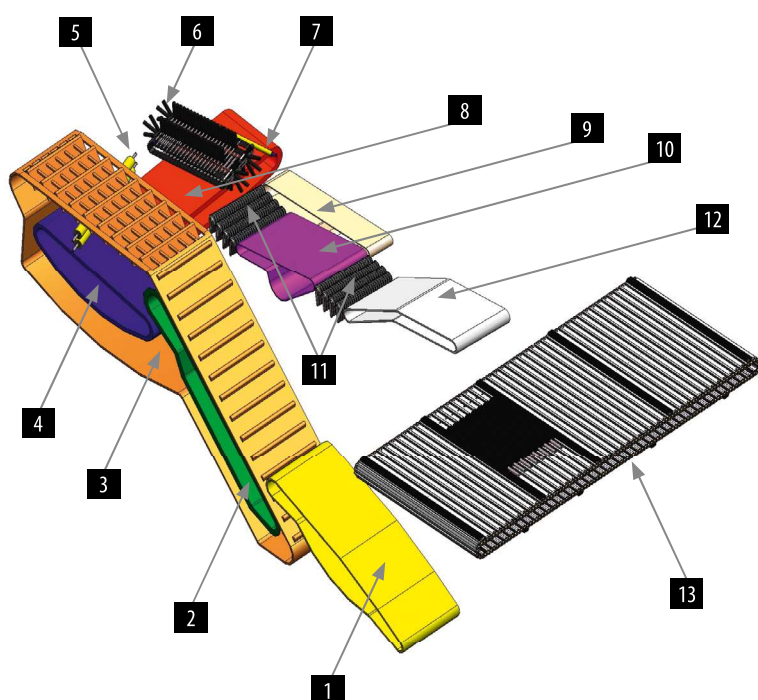

mechanical drive from power take-off (PTO)

- sieving belt 1
- second conveyor 2
- haulm separator 3
- first separator 4

hydraulic drive from the independent hydraulic system:

- intake rollers 5
- rod conveyor 6
- intake roller 7
- second separator 8
- waste conveyor with a selective conveyor 9 10
- sorter 1. and 2. – 4 row x 2 11
- intake conveyor 12
- conveyor of the potato hopper 13

smooth hydraulic speed adjustment:

- intake rollers with rod conveyor 5 6
- intake rollers with the second separator 7 8
- waste conveyor with a selective conveyor 9 10

Optional accessories: (potato):

1	5000 kg container	ZST	3 226 €
2	Quick connector in the combine for installing the onion attachment with quick connector	SZK	405 €
3	Hydraulic container for temporary storage of approx. 700kg of sorted potatoes or stones with small potatoes. Controlled by switch, on/off switch near the tank and service platforms	HZK	2 560 €
4	Sliding curtain of the main container	PF	333 €
5	Funnel of the main container (hopper)	ZZG	333 €
6	Hydraulic drive of the waste container with a smooth adjustment of speed independent from the selection table	HO	405 €
7	Hydraulic external disc coulters drive (right) with smooth speed adjustment	HNKT	381 €
8	Hydraulic external disc coulters drive (left) with smooth speed adjustment	HNKTL	405 €
9	Night LED lighting of the sieving belt	ONT	190 €
10	Automatic guidance to the coulters (electric)	AN	1 024 €
11	2-row brush conveyor (paid extra with rod conveyor)	PS2	1 143 €
12	3-row brush conveyor (paid extra with rod conveyor)	PS3	1 512 €
13	4-row brush conveyor (paid extra with rod conveyor)	PS4	1 881 €
14	5-row brush conveyor (paid extra with rod conveyor)	PS5	2 286 €
15	6-row brush conveyor (paid extra with rod conveyor)	PS6	2 655 €
16	Automatic central mechanical lubrication of bearings and pins	ACS	1 857 €
17	Ploughshare bracket with protection against rocks	ZK	286 €
18	Hydraulic engine supporting the conveyor of the potato hopper in case of using a low performance pump (additionally requires 1 pair of hydraulic outputs)	SZG	286 €
19	Revolving warning light	LO	143 €
20	Anti-dust shields of the conveyor – lower + upper	OP	226 €
21	Shade canopy with lighting for the selection table	DP	500 €
22	Side shields with openings to the shade canopy	OB.	250 €

Optional accessories: (onion and carrot):

23	Quick connector attachment (72cm) for harvesting onions or digging beetroots – mass 130kg	PD	1 619 €
24	Quick connector hydraulic-driven attachment (72cm) for harvesting onions or digging beetroots (additionally requires 1 pair of hydraulic outputs), mass 140kg	PDH	1 881 €
25	Attachment (50cm) for harvesting onions or digging beetroots – mass 60kg	PM	810 €
26	Hydraulic-driven attachment (50cm) for harvesting onions or beetroot digging (additionally requires 1 pair of hydraulic outputs), mass 65kg	PMH	1 083 €
27	Digger for carrots or parsley	WM	405 €
28	Attachment for digging and topping carrots or parsley (topper with guidance system + scraper rollers + intake rollers + blade set + support wheels) (additionally requires 1 pair of hydraulic outputs)	PKM	2 417 €
29	Cutter for carrot, parsnip and parsley tops with a control switch for the cutter and topper (with double pump)	SN	4 024 €
30	Haulm separator (wide separation belt) for carrots or parsley	OL	1 750 €
31	Second conveyor (bent rod belt) for digging thin carrots	P2	1 345 €



